

# National Class **A** Scow Association

13<sup>th</sup> ANNUAL A SCOW NATIONAL CHAMPIONSHIP  
 23-26 JUNE 2016  
 NATIONAL CLASS A SCOW ASSOCIATION  
 TORCH LAKE YACHT CLUB - Bellaire, MI

## SAILING INSTRUCTIONS

### 1 RULES

- 1.1 The regatta will be governed by the rules as defined in *The Racing Rules of Sailing*.
- 1.2 The class rules of National A Scow Class Association (NCASA) will apply.
- 1.3 The Equipment Rules of Sailing will apply.

### 2 NOTICES TO COMPETITORS

Notices to competitors will be posted on the official notice board(s) located at regatta headquarters

### 3 CHANGES TO SAILING INSTRUCTIONS

Any change to the sailing instructions will be posted before 0915 on the day it will take effect, except that any change to the schedule of races will be posted by 2000 on the day before it will take effect.

### 4 SIGNALS MADE ASHORE

- 4.1 Signals made ashore will be displayed from an RC boat that is docked at regatta headquarters.
- 4.2 When flag AP is displayed ashore, '1 minute' is replaced with 'not less than 45 minutes' in the race signal AP. This changes Race Signals.

### 5 SCHEDULE

#### 5.1

Thursday June 23	Registration	1500-2000
	Practice Start(s)	1800
	Practice Race (Pending participation)	1830
Friday June 24	Competitor's Briefing via VHF Radio Channel 72	0930
	First warning Further Races to follow	1100
	Post race party (hosted)	After racing
Saturday June 25	First warning Further Races to follow	1100
	Cocktails and Dinner	1800
Sunday June 26		
	First warning Further Races to follow	1000
	No Warning signal after	1300
	Lunch/Prize Giving	After racing

- 5.2 The series will be six (6) races.
- 5.3 As many races as possible will be sailed each day, per fleet guidelines.
- 5.4 After a long postponement, to alert boats that a race or sequence of races will begin soon, an orange flag will be displayed with

one sound at least four minutes before a warning signal is displayed.

## 6 CLASS FLAGS

6.1 The class flag will be in A Scow insignia on or numeral pennant #1.

## 7 RACING AREAS

7.1 Attachment A shows the location of racing areas.

## 8 THE COURSES

8.1 The diagrams in Attachment B illustrate some of the courses.

8.2 No later than the warning signal, the race committee signal boat will display the course, approximate compass bearing and distance of the first leg.

Example:

<b>5</b>		<i>Course</i>
<b>300</b>		<i>Approximate magnetic bearing to Mark 1</i>
<b>1.5</b>		<i>Approximate distance to Mark 1. (nautical miles)</i>

**Course 3: (3 Legs) Start - 1 - 1a - Gate (2S/2P) - Finish (Upwind) - not illustrated in attachment B**

**Course 4:(4 Legs) Start - 1 - 1a - Gate (2S/2P) - 1 - 1a - Finish (Downwind)**

**Course 5:(5 Legs) Start - 1 - 1a - Gate (2S/2P) - 1 - 1a - Gate (2S/2P)- Finish (Upwind)**

**Course 6:(6 Legs) Start - 1 - 1a - Gate (2S/2P) - 1 - 1a - Gate (2S/2P)-1-1a- Finish (Downwind)**

**Course 7:(7 Legs) Start - 1 - 1a - Gate (2S/2P) - 1 - 1a - Gate (2S/2P)- 1-1a-Gate(2S/2P) -Finish (Upwind)**

**Course 8:(8 Legs) Start - 1 - 1a - Gate (2S/2P) - 1 - 1a - Gate (2S/2P)- - 1 - 1a - Gate (2S/2P)-1-1a- Finish (Downwind)**

**Course 9:(9 Legs) Start - 1 - 1a - Gate (2S/2P) - 1 - 1a - Gate (2S/2P)- 1 - 1a - Gate (2S/2P)- 1-1a- Gate(2S/2P) -Finish (Upwind)**

**Course 10:(10 Legs) Start - 1 - 1a - Gate (2S/2P) - 1 - 1a - Gate (2S/2P)- - 1 - 1a - Gate (2S/2P)- - 1 - 1a - Gate (2S/2P)-1-1a- Finish (Downwind)**

8.3 Marks 1 and 1a shall be rounded to port. Mark 1a is an offset mark and will be positioned to port of Mark 1.

8.4 Gate Marks:

(a) If only one Gate mark is set, boats shall round the single mark to port.

(b) Except when there is a change of course, the Gate will be positioned approximately to windward of the RC Signal Boat.

(c) The Gate may be laid after the starting signal.

8.5 Except when there is a change of course:

(a) the finish for course 4, 6, 8, and 10 will be to leeward of the Gate; and

(b) the finish for courses 3, 5, 7, and 9 will be to windward of Mark 1.

## 9 MARKS

1 - Original Windward mark	Yellow cylinder
1A - Offset mark	Yellow cylinder
1 - Change Windward mark	Yellow cylinder
2S -2P -Leeward gate marks	Yellow cylinder
Start/Finish mark	RC boat or Yellow cylinder

## 10 THE START

10.1 The starting line will be between a staff displaying an orange flag on the starting mark at the starboard end and either the port-end starting mark or a staff displaying an orange flag on the port end committee boat.

10.2 A boat starting later than 10 minutes after her starting signal will be scored Did Not Start without a hearing. This changes rules A4 and A5.

- 11 CHANGE OF THE NEXT LEG OF THE COURSE**
- 11.1 To change the next leg of the course, the race committee will lay a new mark (or move the finishing line) and remove the original mark as soon as practicable. When in a subsequent change a new mark is replaced, it will be replaced by an original mark.
- 11.2 A Green or red flag may be substituted for green or red shapes. This changes RRS 22.a.2.
- 12 THE FINISH**
- 12.1 The finishing line will be between a staff displaying an orange flag on the Committee Boat at the starboard end and the port-end finishing mark.
- 13 PENALTY SYSTEM**
- 13.1 Rule 44.1 is changed so that the Two-Turns Penalty is replaced by the One-Turn Penalty.
- 14 PROTESTS AND REQUESTS FOR REDRESS**
- 14.1 Protest forms are available from the PRO/Chief Judge after sailing and will be located at HQ. Protests and requests for redress or reopening shall be delivered there within the appropriate time limit.
- 14.2 For each class, the protest time limit is 90 minutes after the last boat has finished the last race of the day.
- 14.3 Notices will be posted no later than 30 minutes after the protest time limit to inform competitors of hearings in which they are parties or named as witnesses. Hearings will be held as directed by the protest committee, location and time will be posted on the official notice board.
- 14.4 Notices of protests by the race committee or protest committee will be posted to inform boats under rule 61.1(b).
- 14.6 Breaches of instructions 10.2 and 18, will not be grounds for a protest by a boat. This changes rule 60.1(a). Penalties for these breaches may be less than
- disqualification if the protest committee so decides. The scoring abbreviation for a discretionary penalty imposed under this instruction will be DPI.
- 14.7 On the last scheduled day of racing a request for reopening a hearing shall be delivered
- (a) within the protest time limit if the requesting party was informed of the decision on the previous day;
- (b) no later than 30 minutes after the requesting party was informed of the decision on that day.
- This changes rule 66.
- 14.8 On the last scheduled day of racing a request for redress based on a protest committee decision shall be delivered no later than 30 minutes after the decision was posted. This changes rule 62.2.
- 14.9 A boat intending to protest shall notify the Race Committee on the signal boat promptly upon crossing the finish line of the race, in which the protest occurred, of the intent to protest and the boat or boats protested. This changes RRS 61.1 .A protest is invalid when this notification is not made at the finish and the Protest Committee may refuse to hear the protest under RRS 63.5. This changes RRS 63.5.
- 15 SCORING**
- 15.1 The low point scoring system of RRS Appendix A will be used except that no scores will be excluded. This modifies RRS A2.
- 15.2 One (1) raced is required to be complete to constitute a series.
- 16 REPLACEMENT OF EQUIPMENT**
- 16.1 Substitution of damaged or lost equipment will not be allowed unless authorized by the race committee. Requests for substitution shall be made to the

committee at the first reasonable opportunity.

**17 EQUIPMENT AND MEASUREMENT CHECKS**

A boat or equipment may be inspected at any time for compliance with the class rules and sailing instructions. On the water, a boat can be instructed by a race committee equipment inspector or measurer to proceed immediately to a designated area for inspection.

**18 RADIO COMMUNICATION**

18.1 The RC will use VHF radio to communicate to the fleet. Failure to make this broadcasts or failure to hear the broadcast shall not constitute grounds for granting redress. This changes rule 62.1.

18.2 Except in an emergency, a boat shall neither make radio transmissions while racing nor receive radio communications not available to all boats. This restriction also applies to mobile telephones.

**19 PRIZES**

19.1 Prizes will be given as follows: Top ten (10) finishers, the top finisher of the hull built

prior to 1995, and the top finisher of the hull prior to 2005.

19.2 Additional prizes may be given at the discretion of the organizing authority.

**20 DISCLAIMER OF LIABILITY**

Competitors participate in the regatta entirely at their own risk. See rule 4, Decision to Race. The organizing authority will not accept any liability for material damage or personal injury or death sustained in conjunction with or prior to, during, or after the regatta.

**21 INSURANCE**

Each participating boat shall be insured with valid third-party liability insurance.



Mark DeGuire  
Principal Race Officer  
262-701-7133 (cell)  
mdeguire@wi.rr.com

# Attachment A Racing Area

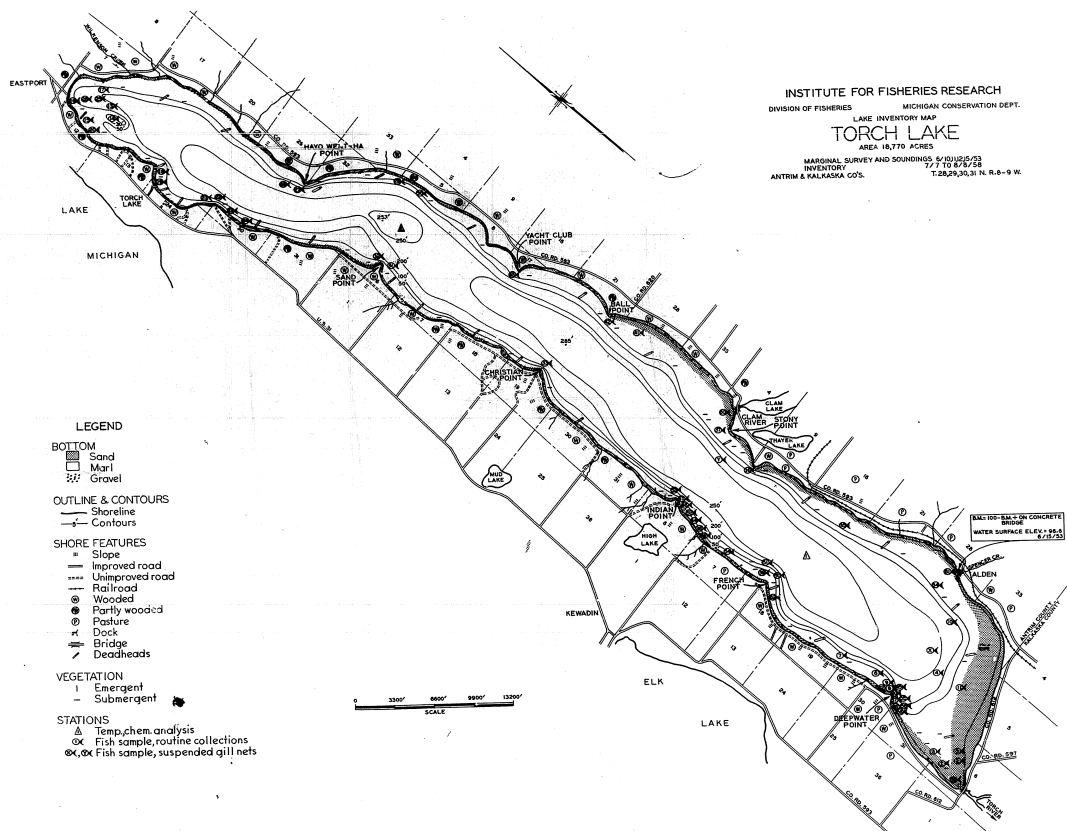

Attachment B

Course 3, 6, 7, 8, 9, 10 – not illustrated

**COURSE 4**

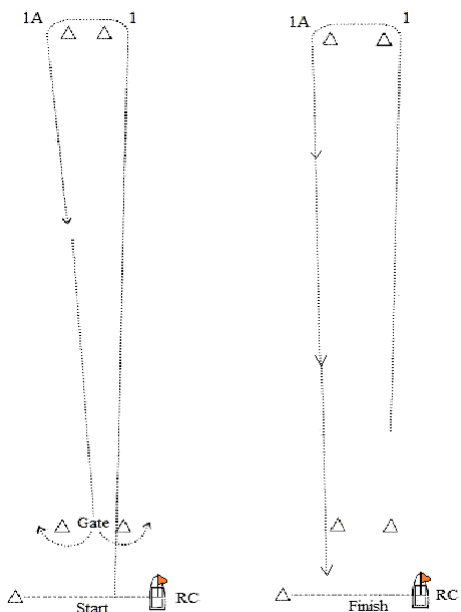

Start – 1 – 1A – Gate (2S/2P) – 1 – 1A –  
Finish

Start – Finish may be between either the RC  
boat displaying an orange flag and a nearby  
mark

or

between two RC boats each displaying an  
orange flag.

**COURSE 5**

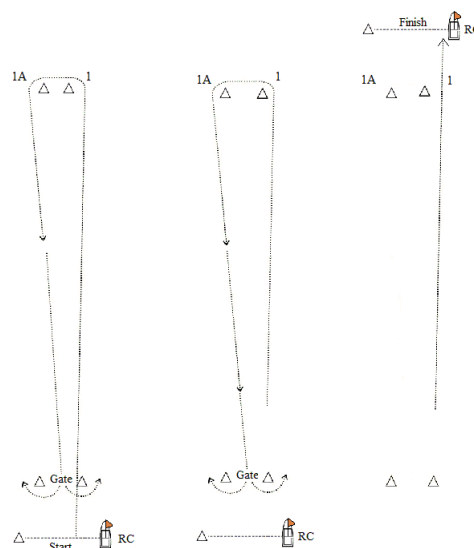

Start – 1 – 1A – Gate (2S/2P) – 1 – 1A –  
Gate (2S/2P) - Finish

Start – Finish may be between either the RC  
boat displaying an orange flag and a nearby  
mark

or

between two RC boats each displaying an  
orange flag.